

# Standard pulse operated latching relays

## DESCRIPTION / APPLICATION

This impulse relay used for lights, refrigerators ,TV Sets and other domestic appliance.

## MAIN FUNCTIONS

Start up Power Consumption: 25VA

Rated Current: 16A 250V

Life Time: 150000 times

Mechanical Life Time: 500000 times



## APPLICATION METHOD

Connecting the load with Terminal 1 and Terminal 3, and connected the impulse signal with coils terminal A1 and A2. Check with drawing.1

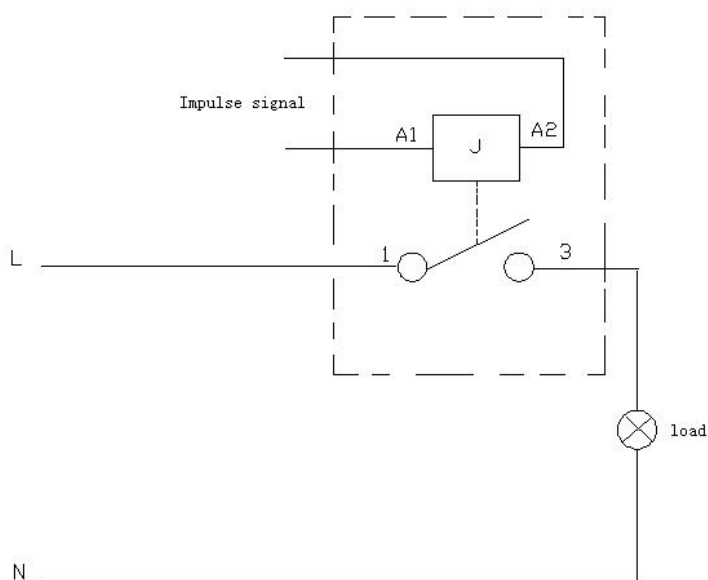

**Drawing 1**

Load  $\leq 16A$ ,  $0.1s < \text{impulse signal} < 0.5h$ .

85% Rated coil voltage  $\leq$  Control Voltage  $\leq$  110% Rated coil voltage.

Please check the printing on the products.

The Frequency for this impulse relay with load should less than 12times/minute.

The impulse relay main contactors are “ON” at the handle “I” position, and “OFF” at the handle “O” position. And the handle positions can be adjusted by changing both from handle operation and impulse signal “A1 and A2”.

With each connection of the impulse signal, the main contactors change and keep this variety until the next changing from impulse signal or handle.

i.e. The handle at “O”(the main contactors OFF), after putting a impulse signal, the Main contactors are ON (the handle at “I” position) , and the impulse relay keep “ON”.

After another impulse signal, the handle changed from “I” to “O”, and the main contactors from “ON” to “OFF” accordingly. And circling like that.

### OPERATING ENVIRONMENT

Temperature: -5°C~+40°C

Storage Temperature: -40°C~+80°C

Electromagnetic Pollution grade: 3

The inclination should less than  $\pm 5$  if with vertical installment

The cables for coils and load should be with soft wire less than 6mm<sup>2</sup> or hard wire less than 10mm<sup>2</sup>.

### INSTALLATION AND EXTERNAL DIMENSION, please check the drawing 2

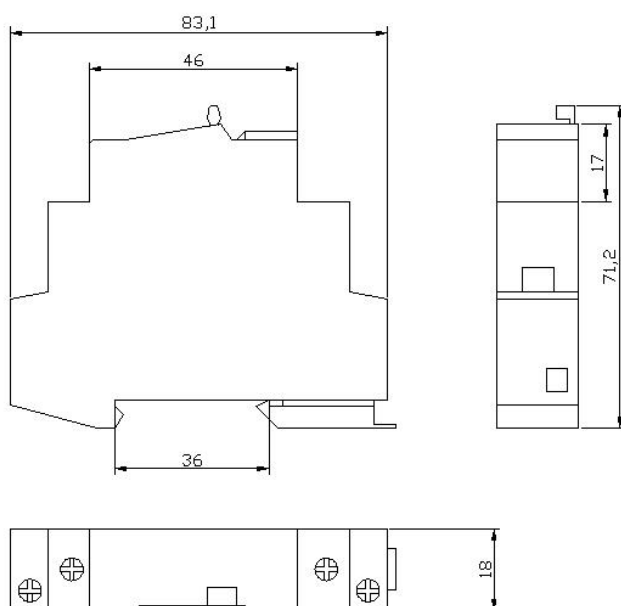

**Drawing 2**