

## RCCBs DX<sup>3</sup>-ID-2P/4P Residual Current Circuit Breakers



### DESCRIPTION / APPLICATION

RCCBs with positive contact indication for control, protection and isolation of electrical circuits, protecting people from direct and indirect contact and protecting installations from insulation faults.

### TECHNICAL DATA

<b>The number of poles</b>	2P	4P
<b>Rated current</b>	6-63A	6-63A
<b>Rated voltage</b>	230V	415V
<b>Rated frequency</b>	50/60Hz	50/60Hz
<b>Sensitivity</b>	30mA 100mA	300mA 500mA
<b>Way of release</b>	M: 2P	M: 4P
	E: 2P	E: 4P
<b>Rated breaking capacity</b>	6kA	
<b>Utilization category</b>	A	
<b>Mechanical life</b>	20000	
<b>Protection degree</b>	IP20	
<b>Ambient temperature</b>	-25~65°C	
<b>Installation environment</b>	NO obvious impact and vibration	
<b>Mounting</b>	Standard DIN 35 rail	

## OVERALL DIMENSIONS

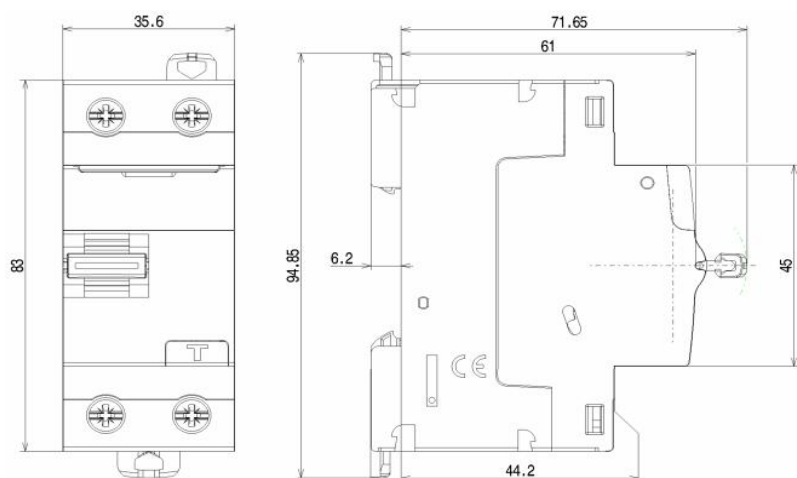

**2P**

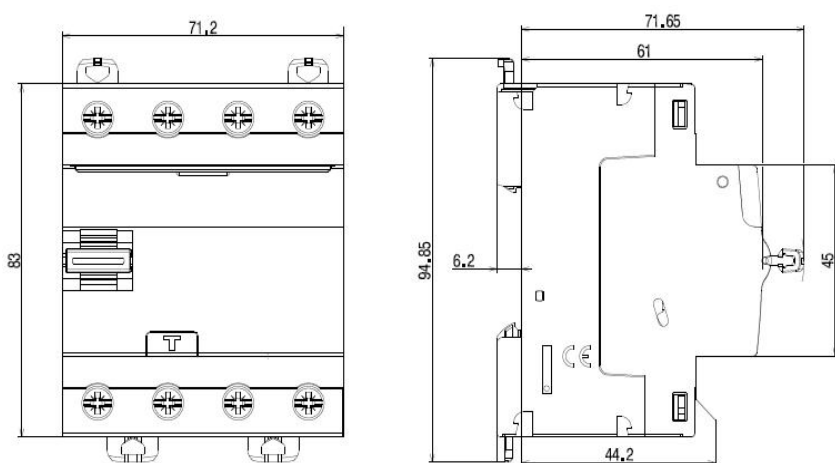

**4P**