

RT16-3 (Fuse Holder)

NT3(Fuse link) Low voltage AC fuse



Application

This series fuse is mainly used for protecting the electrical circuit against overload and short-circuits(gG/gL). Because of different melting tablets, it also may derive for protecting the semiconductor device and others complete set installment from short-circuit (aR/gR/gS/gtr) as well as the electric motor from short-circuit (aM).

Structural Characteristics

- According to IEC60269-6
- Rated current: 315-630A
- Rated voltage: AC 690V
- Square Pipe Knife-shape Contact Fuse

Specification

Rated Voltage U_e (V AC)	690V
Rated Current I_n (A)	315,355,400,425,500,630
Biggest Block Ability(KA)	50

Connection and Installation

Working Temperature(°C)	-5~+40
Resistance And Damp Hot	Class 2
Altitude(m)	≤ 2000
Relative Humidity	≤ 95%
Protection Class/Degree	IP20
Pollution	3
Installation Environment	No obvious shock and vibration
Installation Class/Type	Class III/DIN rail

Dimensions(mm)

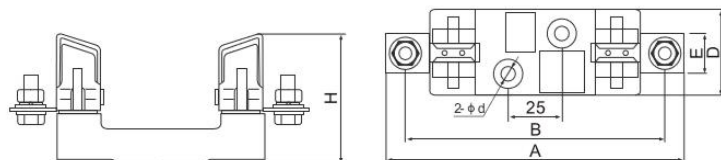

A/B/D/E/H: 250/210/60/30/105

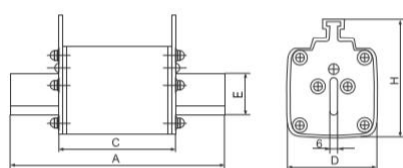

A/C/D/E/H: 150/68/68/32/84

Characteristic Curve

